

ENTRY MARKER PLAN

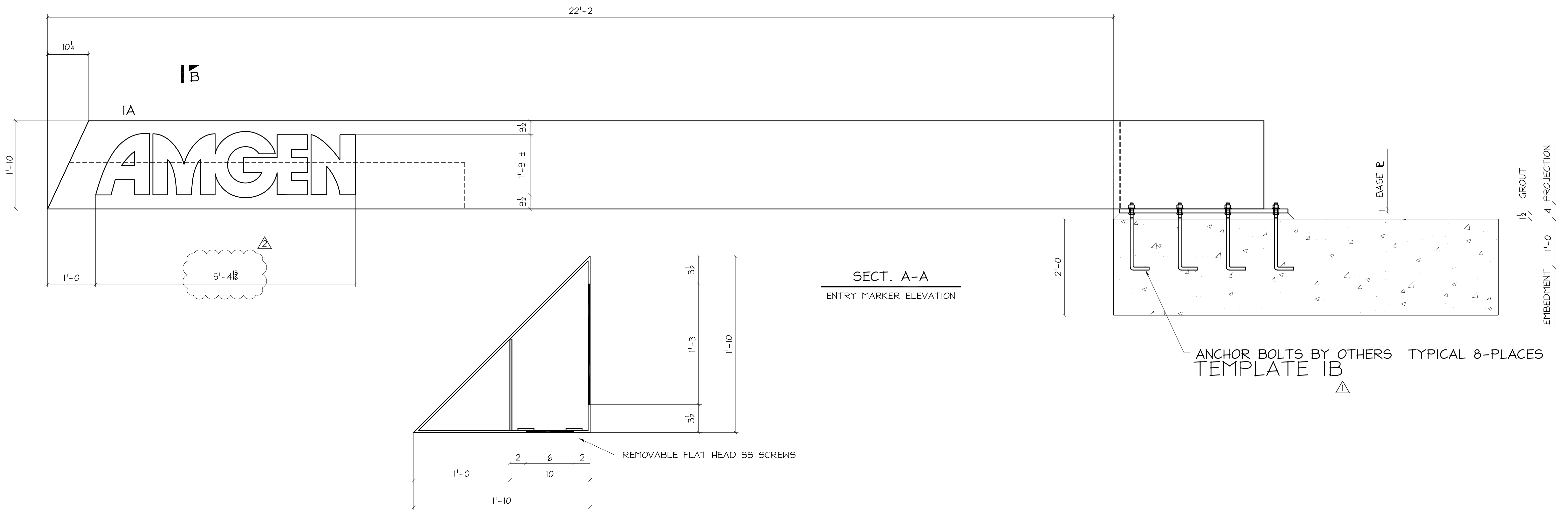

SECT. A-A
ENTRY MARKER ELEVATION

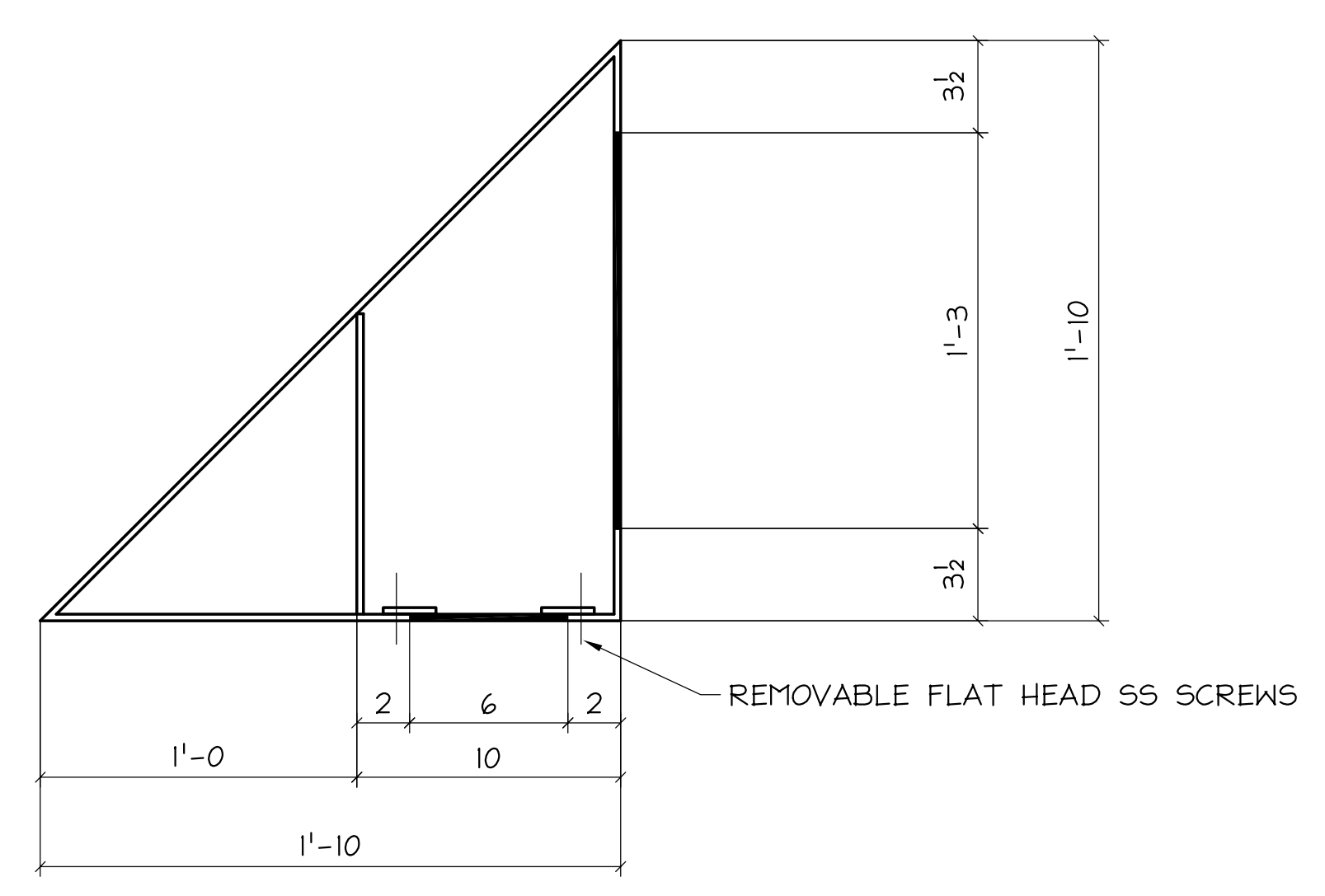

SECT-B

REV	DATE	BY	DESCRIPTION	DWG STATUS	DATE
2	11/10/03	GA	UPDATE LOGO / ISSUE FOR FABRICATION		
1	11/6/03	GA	IFF - TEMPLATE ONLY		

HELIX PROJECT
ENTRY MARKER
SEATTLE, WASHINGTON

ENGR: **kpff** ADI / ANGLE DETAILING, INC.
CONTR: ADI JOB# 2003-317

COLUMBIA WIRE & IRON WORKS
5555 N. Channel Portland, Ore. 97217
www.cwil.com/503-286-6600

DRAWN BY: **ga** CHKD BY: **GBA** JOB NO. **67-004001** DWG. NO. **E1**

VERIFICATION OF DIMENSIONS, DETAILS, AND ETC. ARE REQUESTED WHERE INDICATED. IF EACH VERIFICATION IS NOT NOTED OTHERWISE, IT WILL BE ASSUMED TO BE CORRECT AS SHOWN